



7 Moorebank Road Cliftleigh NSW

4  2  2 

Located in a central position between Maitland and Kurri Kurri, stands this low maintenance, single-level home proudly situated on the high side of the street.

Built in 2013, this brick and tile home provides a genuine opportunity for investors and first homebuyers with the thriving region expected to provide outstanding capital growth.

Features include:

? Low maintenance single-storey home with internal access via large double garage

? Four bedrooms, all appointed with built-in wardrobes - Master with ensuite and walk-in robe.

Price : \$ 670,000
Land Size : 450 sqm
View : <https://www.ellejayne.com.au/sale/nsw/hunter-valley-lower/cliftleigh/residential/house/7074120>



Ben Wrigley
1300 322 366



Jayse Russo
(02) 4973 2775

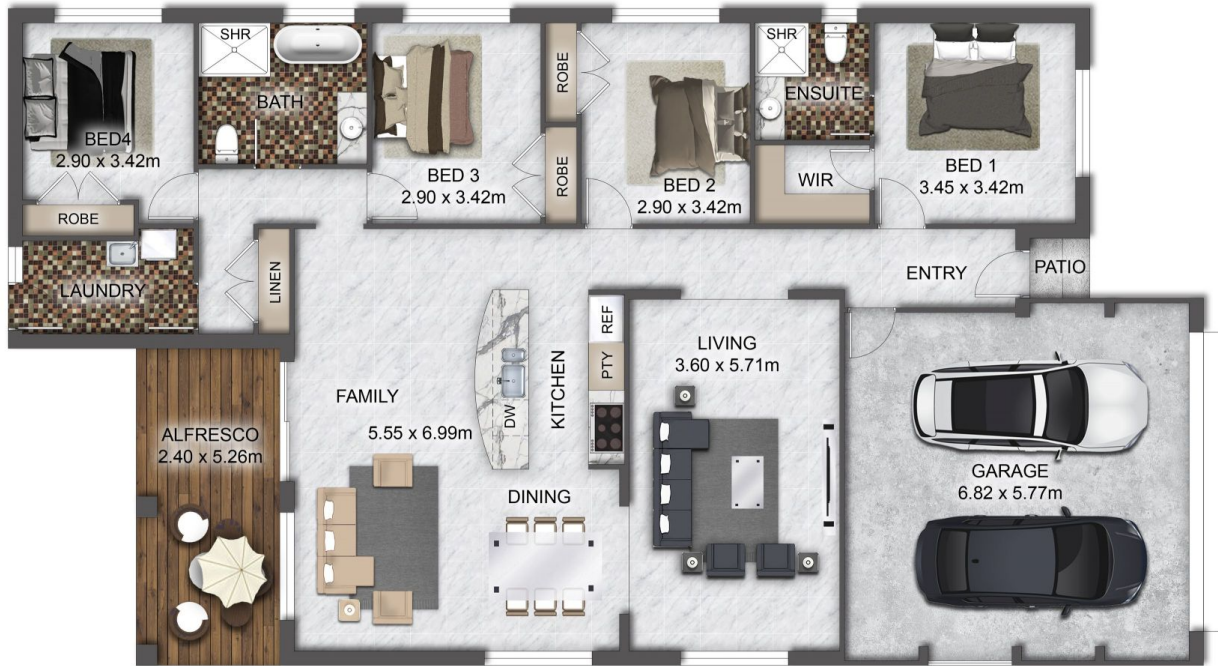

FLOOR PLAN

This floor plan including furniture, fixture measurements and dimensions are approximate and for illustrative purposes only. BoxBrownie.com gives no guarantee, warranty or representation as to the accuracy and layout. All enquiries must be directed to the agent, vendor or party representing this floor plan.

LIVING	165.3 sqm
GARAGE	35.5 sqm
PATIO	1.1 sqm
TOTAL	201.9 sqm

7 Moorebank Road Cliffeigh